

**Important Note: Documents can be downloaded via the County Website and printed in larger format.**

**[www.oconeecounty.net/](http://www.oconeecounty.net/)**

# **Drawings**

**Bid Control Number 200905-001**



**2007-2008 TRANSPORTATION IMPROVEMENTS AND MAINTENANCE PROGRAM**

**INTERSECTION IMPROVEMENT  
WHITE OAK DRIVE & US 441**

**Oconee County Board of Commissioners**

**Public Works Department**

**Publish Date: May 7, 2009**

**Bid Opening Date & Time: May 21, 2009; 9:00 A. M.**

**Place: Commission Chambers located in the Oconee County Courthouse  
23 N Main Street  
Watkinsville, GA 30677  
706.769.2944**

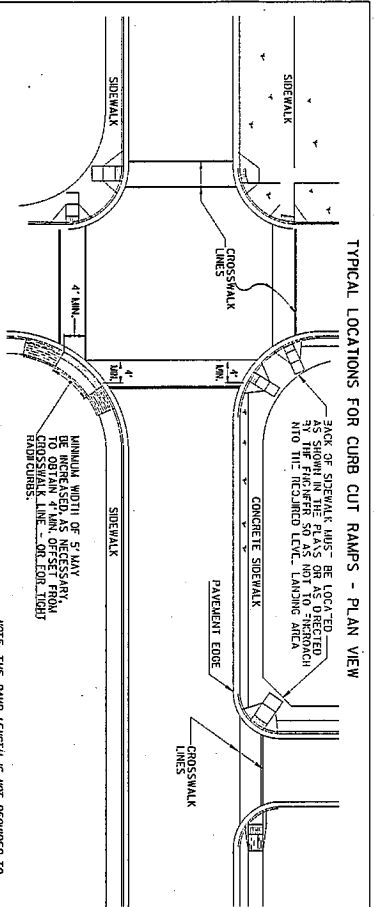

NOTE: THE RAMP LENGTH IS NOT REQUIRED TO EXCEED 10 FEET. THE SITE CONDITIONS MAY PREVENT THE USE OF A RAMP IS FEET LONG.

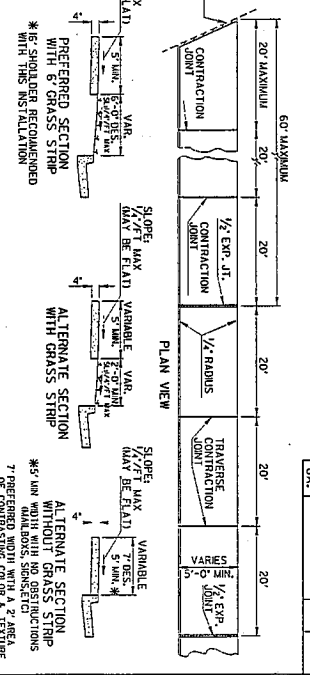
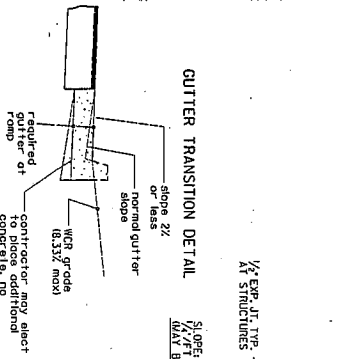

STATE	PROJECT NUMBER	SHEET	TOTAL SHEETS
GA.		A3	

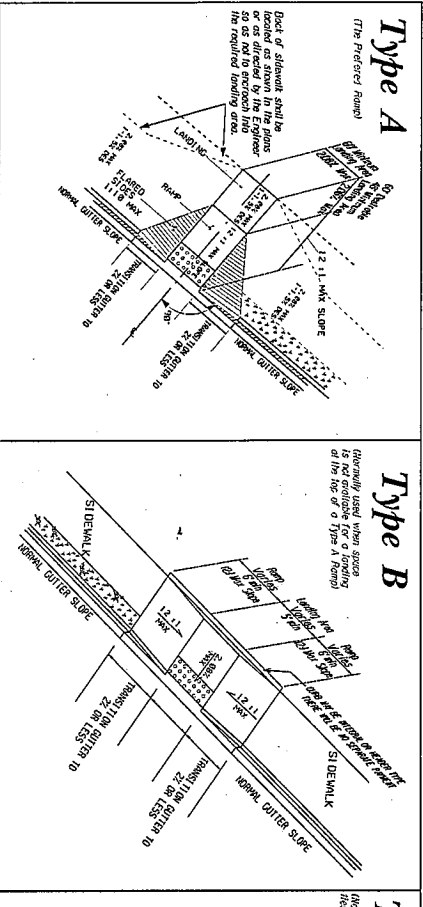

**Type A**  
(The Preferred Ramp)

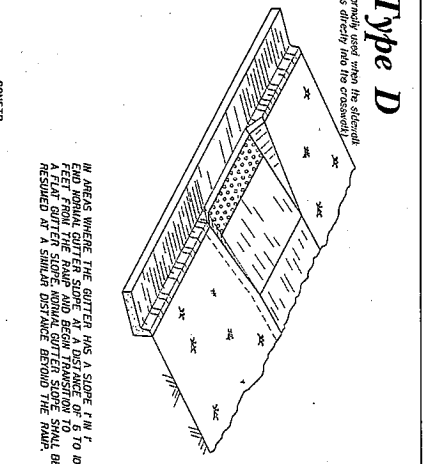

**Type B**  
(Normally used when space is limited and the width of the ramp is less than 5 feet.)

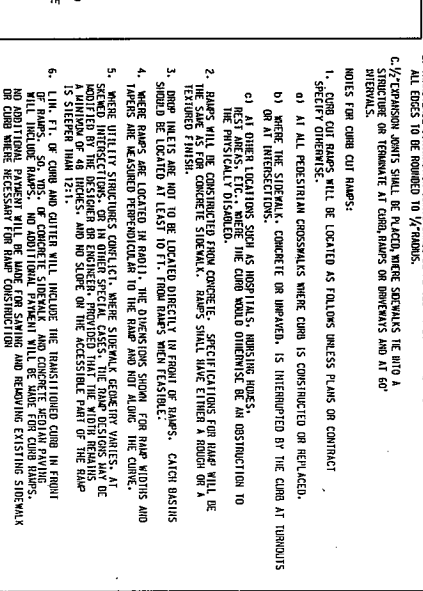

**Type D**  
(Normally used when the sidewalk has directly into the crosswalk.)

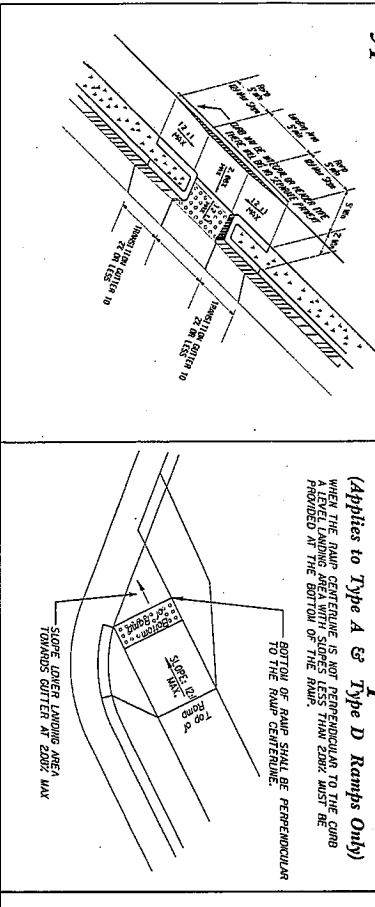

**Type C**

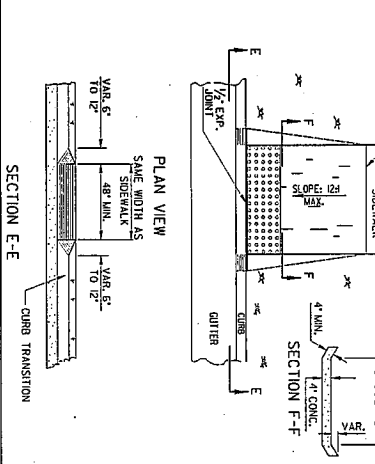

**Skewed Ramp Details**  
(Applies to Type A & Type D Ramps Only)  
WHEN THE RAMP CENTERLINE IS NOT PERPENDICULAR TO THE CURB, THE RAMP CENTERLINE SHALL BE PERPENDICULAR TO THE RAMP CENTERLINE.

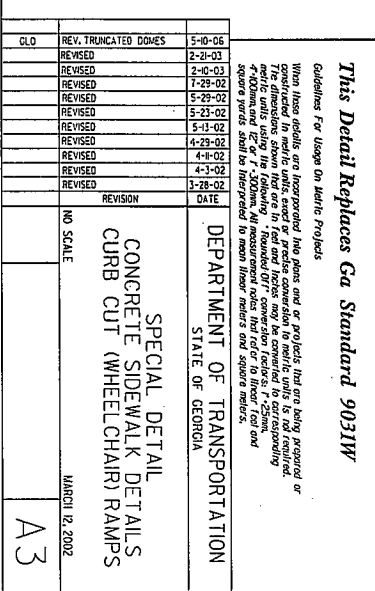

**SECTION E-E**  
**SECTION F-F**





EXIT RAMP

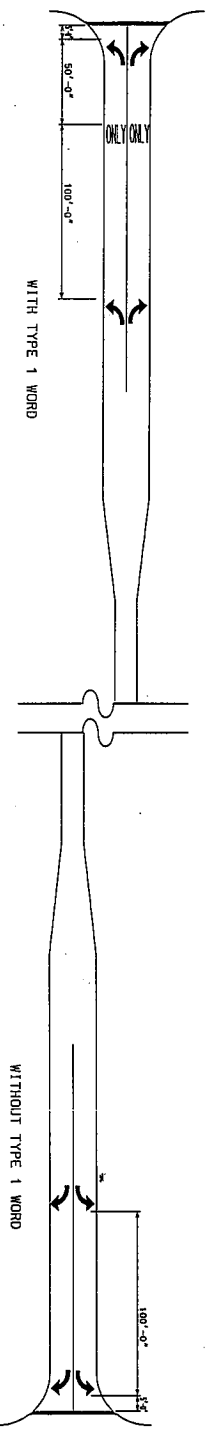

SHORT TURN LANES

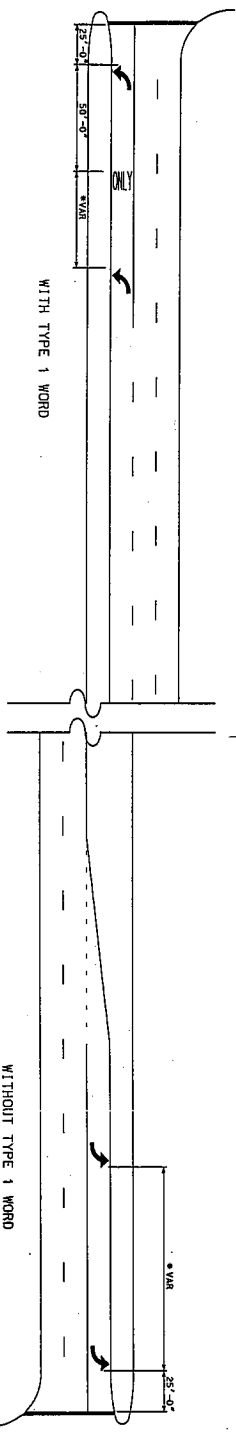

\* ADJUST TO MEET LOCAL CONDITIONS (NOT LESS THAN 50' NOR MORE THAN 100')

LONG TURN LANES

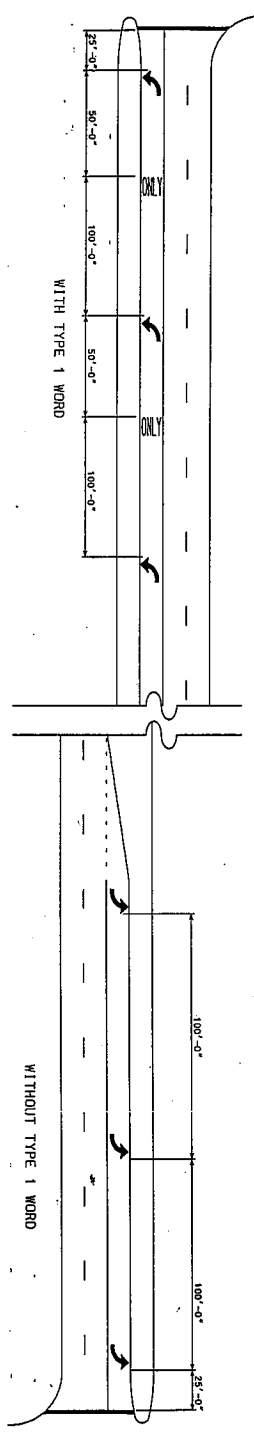

- GENERAL NOTES:
1. SPACING OF TYPE 2 ARROW IS REPRESENTATIVE OF SPACING FOR TYPE 1, TYPE 3, TYPE 4, & TYPE 5 ARROWS.
  2. ALL TURNING LANES SHALL HAVE A MINIMUM OF 2 ARROWS.
  3. GROUND MOUNTED OR OVERHEAD SIGNING SHALL BE SUPPLEMENTED BY TYPE 1 WORD.

DATE	REVISIONS	GEORGIA DEPARTMENT OF TRANSPORTATION OFFICE OF TRAFFIC SAFETY & DESIGN
		DETAILS OF PAVEMENT MARKING ARROW LOCATION
		NO SCALE
		JANUARY 2000

PLAN	PROJECT NUMBER	PROJECT TOTAL
G.A.		NO. SHEETS



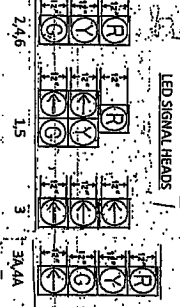
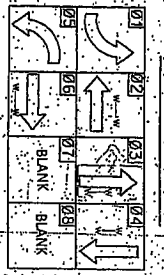
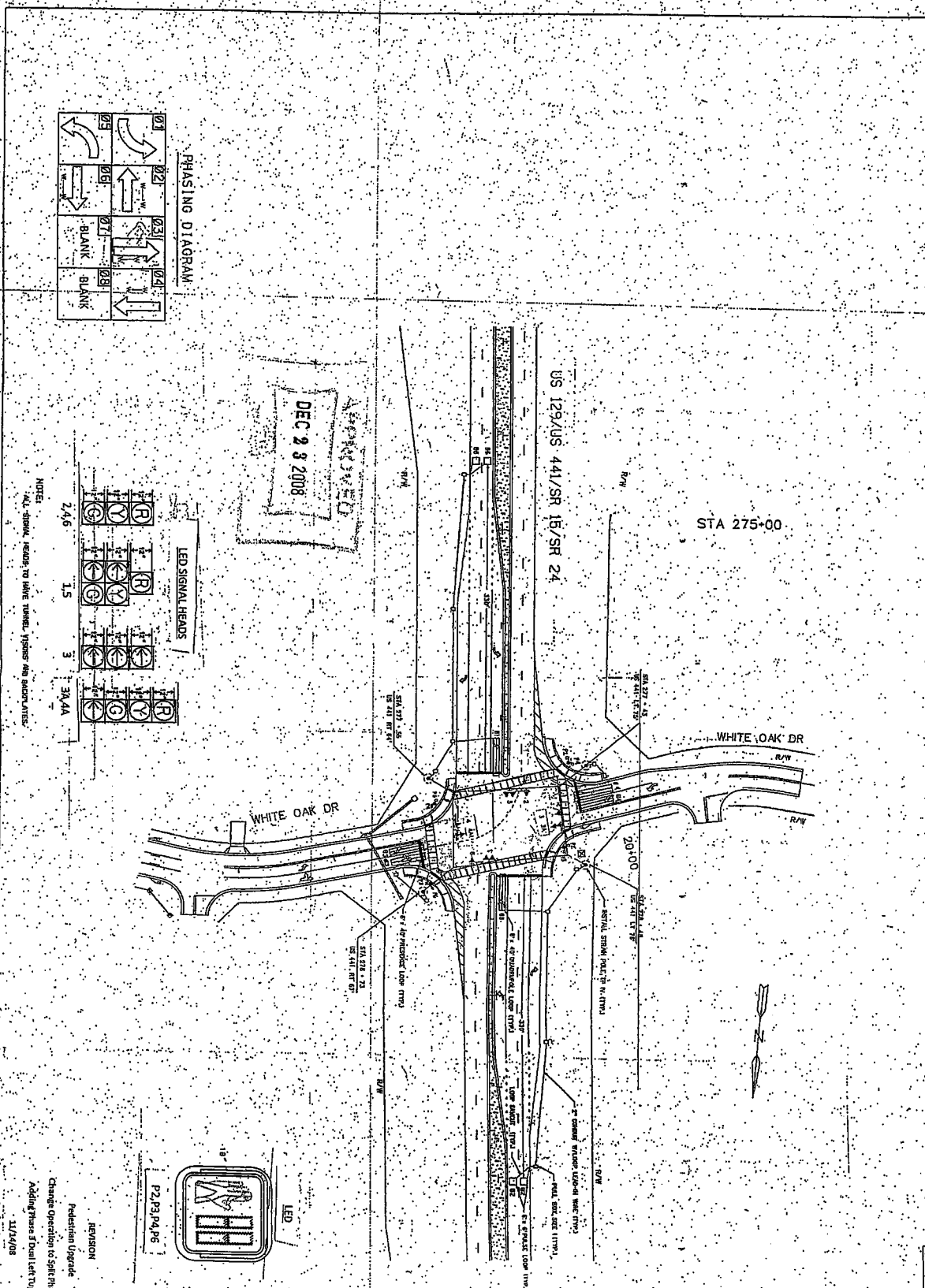

**NOTES**  
 ALL SIGNAL HEADS TO HAVE TURNED VISION AND SUBCANTILE.

**REVISION**  
 Change Operation to Split Phase  
 Adding Phase 5 Dual Left Turn  
 11/24/08

PROJECT: US 441/SR  
 TRAFFIC SIGNAL  
 WHITE OAK  
 PROJECT NUMBER: 11/24/08

DATE	BY	PROJECT NUMBER	REVISION